

CERTIFIED RECORD OF LAND CORNER MONUMENTATION

History of original corner establishment:
None

*

DIAGRAM
T17S R29E
C1/4
+
S19

Description of corner evidence found:
None

Description of monument and accessories I establish to perpetuate the original location of this corner:

Set a 3/4 x 28" aluminum monument 21" in the ground in a mound of stone.

I establish new bearing trees:

A 14" P.Pine bears S85 1/2° E, 17.3 ft, scribed C1/4S19BT.

A 12" Fir bears N23 1/2° W, 16.9 ft, scribed C1/4S19BT.

T17S R29E
C1/4
+
S19
PLS1918
1988

New BTs have 3/4" brass washers marked PLS1918 attached to the BT blaze, faces and bands painted with red tree marking paint, and BT tags and Attention or Land Survey Monument signs. A steel fence post with Attention or Land Survey Monument sign is driven approximately 3-5 feet from the corner.

Smokey Cadastral Survey, Cont. No. 53-04H1-7-4011

Field Book: FB 4-5.

Work accomplished: 7/6/88

Witnesses: Douglas Parsons

Louise Parsons

Job No.: 87226

PARSONS SURVEYING
1915 S.E. Stone Street
Corvallis, OR 97333
(503) 752-7515

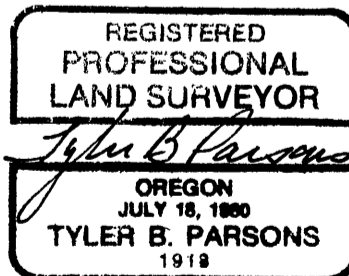

Office of COUNTY SURVEYOR

County of GRANT

State of OREGON

, I hereby certify that the within instrument was filed in this office for record on the 4 day of Nov, 1988

Robert D. Buzott

(COUNTY OFFICIAL)

by _____

(DEPUTY)